

Datasheet

Type: NS51
Itemnr.: 5100870930001

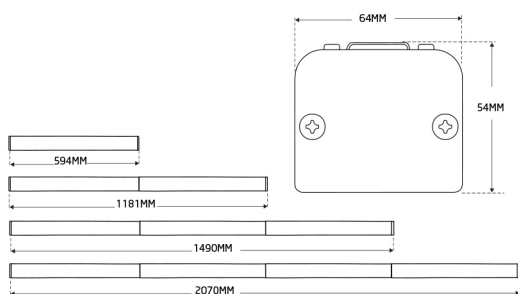
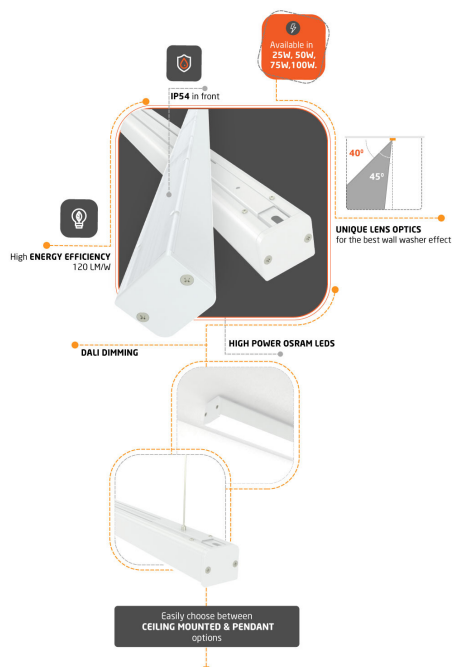

Technical Data

Lumen	4.000lm, 8.000lm, 12.000lm or 16.000lm
Beam Angle	Asymmetric (wall washer)
Colors Available	Warm white, Neutral white, Cold white
Color Temperature	3000K, 4000K, 5000K (Opt Tunable White)
Color Rendering	CRI80 (option CRI90)
MacAdam	Step 3 (Option Step 2)
Consumption	25W, 50W, 75W or 100W
Voltage Range	220 ~ 240VAC 50/60Hz
Current LEDs	700mA
PF Power Factor	>95 @ Full load
Flicker	<1 % Flicker free (IEEE Std. 1789-2015)
10A Fuse Type C	Max. 11 luminaires (Start Current limit)
Leakage current	< 0,5mA @ 240V AC
Efficiency	160 lm/W (LEDs 245 lm/W)
Equal To	NS51 50W = Fluorescent tube T5 80W
Lifetime TM-21	50K hours at Ta = 25°C (L90) B10
Lifetime LEDs	100K hours at Ta = 25°C (L80) B50
Lifetime driver	100K hours at Ta = 25°C (MTBF) B50
Driver Options	DALI, DALI V2 DT8, 1-10V, CLO, Smart Tech
IP Code	IP54 (front)
IK Class	IK07
Class	2, Double Insulated
Working temp	-20 to 45 degree Celsius
Size	H54 x W64 mm x L593, 1181, 1490, 2070
Installation	Wire, wall bracket or ceiling mounted
Linkable cables	Yes, entry for two cables
Material used	Aluminum, PMMA for front lenses
Weight	1,5 Kg - 6.0 Kg (600mm - 2000mm)
Shipping	Package of 4 pcs
IES File	Yes
Certificates	CE, ROHS, TM21, LM80, IES
Other	ENEC, only for driver unit
Warranty	5 years*
Housing	White, black, silver or optional
Included	Complete lamp housing, LEDs, driver

Lumega Europe ApS
Phone +4571995825
info@lumega.eu
www.lumega.eu

